

CORRECT INSTALLATION

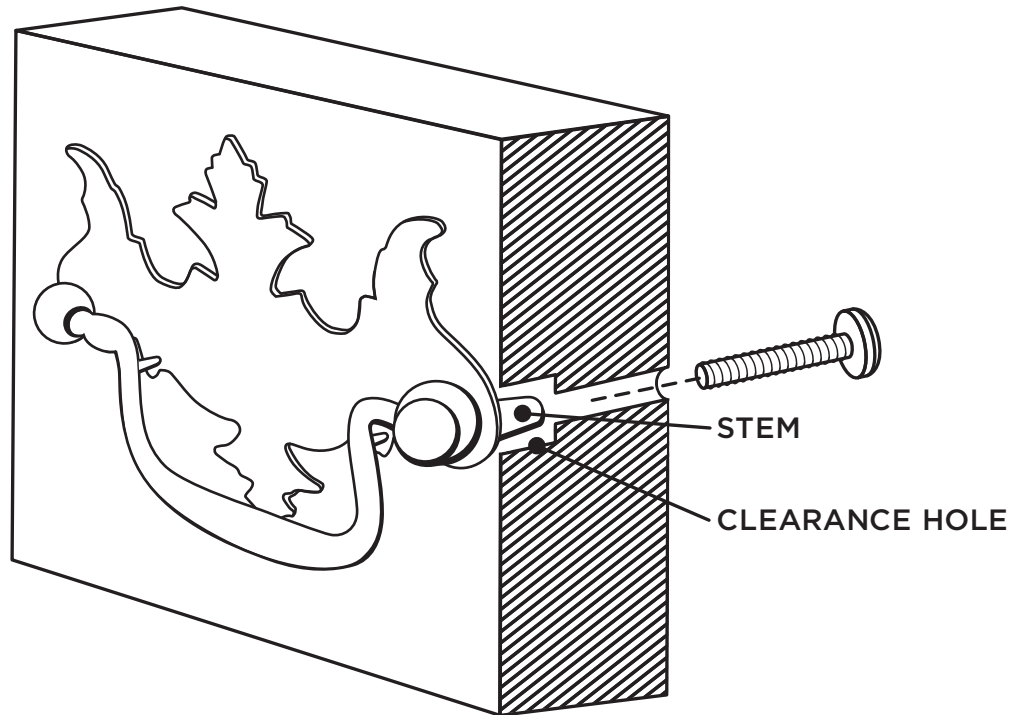

FOR PULL TO SIT FLUSH ON CABINET:

New Installation:

- 1) To mount on cabinet, drill $\frac{3}{16}$ in(4.8mm) hole through cabinet.
- 2) For the stem, use a standard $\frac{1}{4}$ in(6.4mm) drill bit and drill a clearance hole into the front of the cabinet.

Replacement Installation:

- 1) For the stem, use a standard $\frac{1}{4}$ in(6.4mm) drill bit and drill a clearance hole into the front of the cabinet.