

# Installation Guide & User Manual

**EMTEK®**  
ASSA ABLOY

# LISCIO

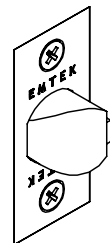
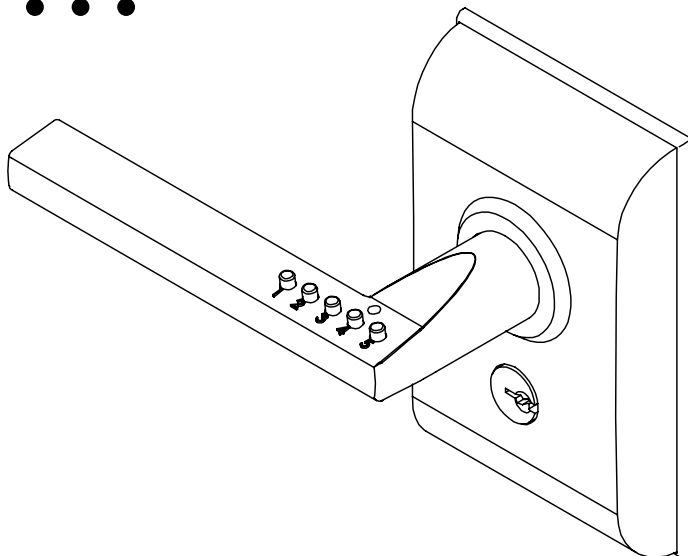

**Electronic Keypad Lever Lockset  
with Bluetooth Programming**

# What's in the Box

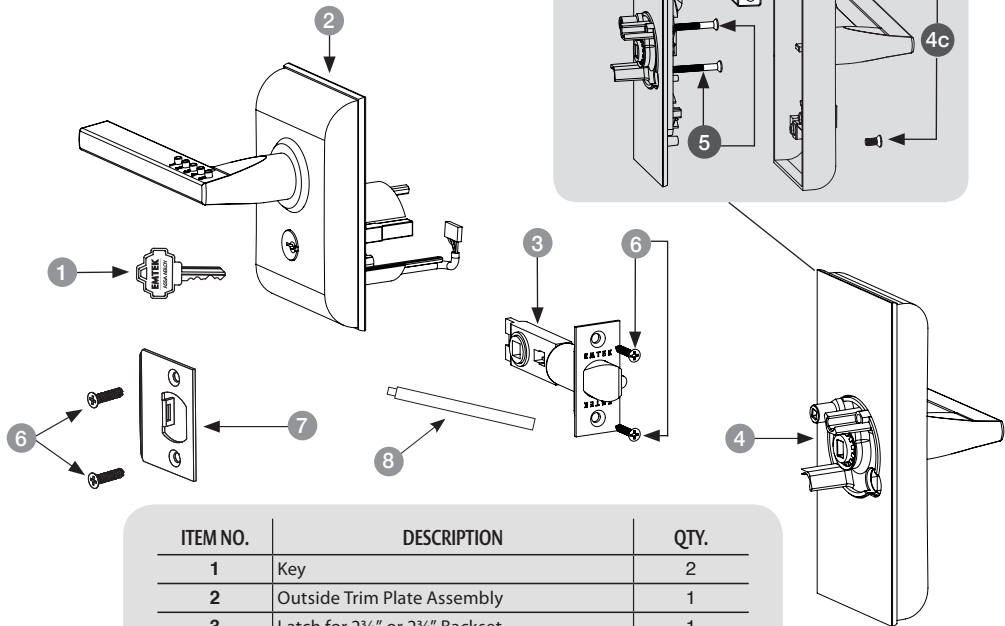

ITEM NO.	DESCRIPTION	QTY.
1	Key	2
2	Outside Trim Plate Assembly	1
3	Latch for 2 $\frac{3}{8}$ " or 2 $\frac{3}{4}$ " Backset	1
4	Inside Trim Plate Assembly	1
4a	Inside Chassis	1
4b	Inside Trim Plate	1
4c	#8-32 x $\frac{3}{8}$ " Flat Head Machine Screw	2
4d	9V Alkaline Battery	1
5	#8-32 x 1 $\frac{1}{2}$ " Flat Head Machine Screw	2
6	#8 x $\frac{3}{4}$ " Wood Screw	4
7	Strike Plate	1
8	Plastic Extender	1

# Preparation

## Confirm Handing

A

EN

**HANDING OF DOOR IS ALWAYS DETERMINED FROM THE OUTSIDE**

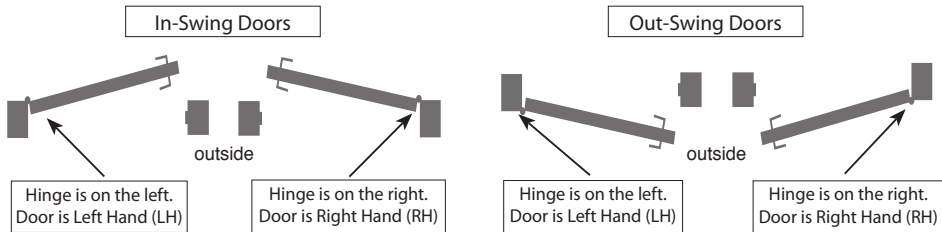

## Door Prep

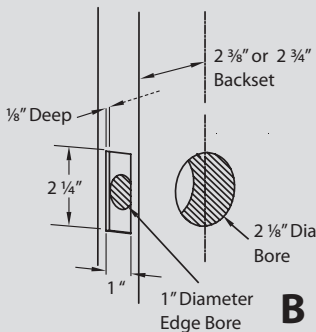

## Door Jamb Prep

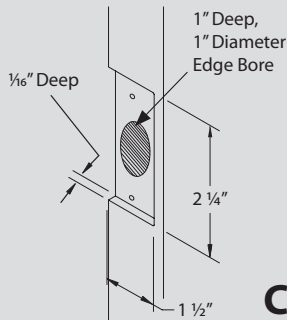

## Install Strike Plate

Fasten Strike Plate using two #8 x 3/4" Wood Screws (item #6).

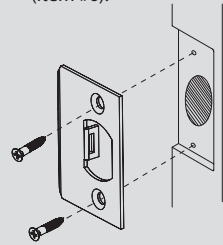

# How to Install

# 1

## Install Latch

Fasten Latch using two #8 x ¾" Wood Screws (item #6).

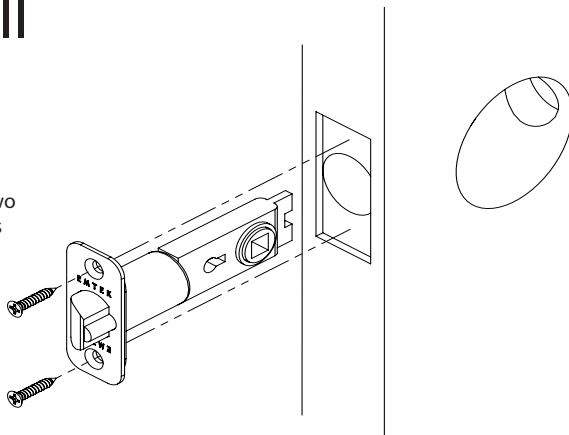

## Remove Screws from Inside Trim Plate

Use a Phillips head screwdriver to remove screws (item #4c) shown below and detach Inside Trim Plate from the Inside Chassis.



*Remove inside chassis from trim plate before installing the outside trim. Thumbturn must be in neutral position.*

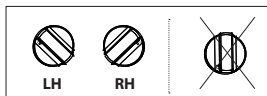

See Page 3 for Handling Information.

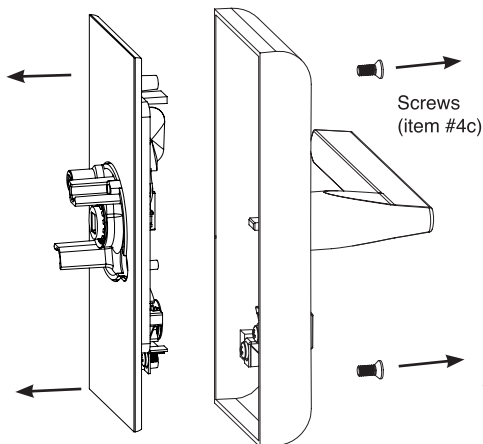

## Install Outside Trim Plate Assembly

### STEP 1

While holding Outside Trim Plate Assembly, Press the Plastic Extender (A) into end of Spindle Shaft (B). The Shaft is properly aligned when the marking 'TOP' can be seen from an overhead view.

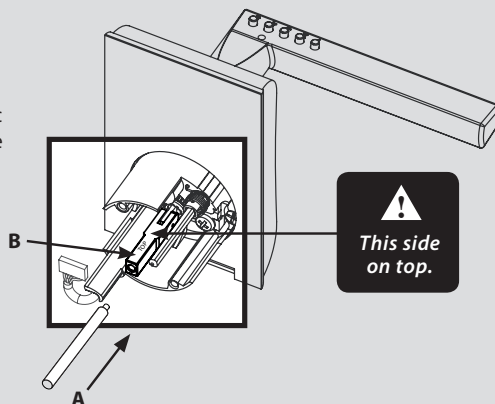

EN

3

### STEP 2

Position the Outside Trim Plate Assembly through the bore hole.

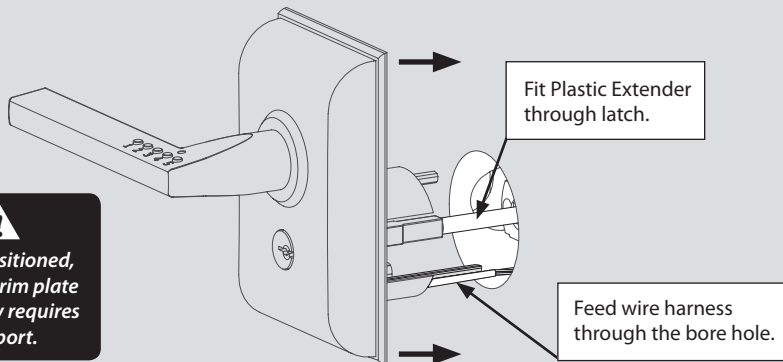

### STEP 3

With the Outside Trim Plate Assembly flush to the door, **REMOVE** the Plastic Extender.

## Install Inside Chassis

### STEP 1

Confirm the position of Cam Link.

#### For Right Hand Locks:

Turn to right position.

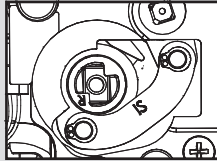

#### For Left Hand Locks:

Turn to left position.

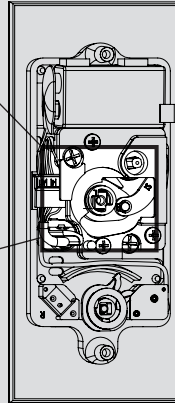
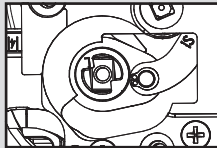

*Cam link must remain  
in the correct position  
during installation.*

### STEP 2

Feed the Wire Harness through Inside Chassis.

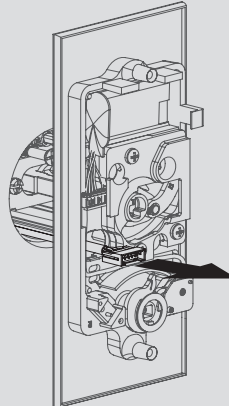

# 4

**STEP 3**

Fasten Inside Chassis using two #8-32 x 1½" Flat Head Machine Screw (item #5).

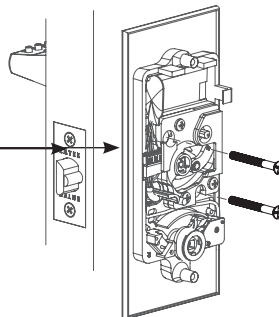

*Check alignment before fully tightening screws.*

**EN****STEP 4**

Connect Wire Harness (A) and tuck Connectors as shown (B).

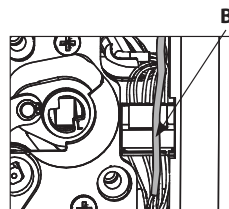
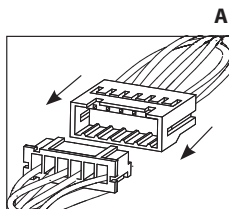
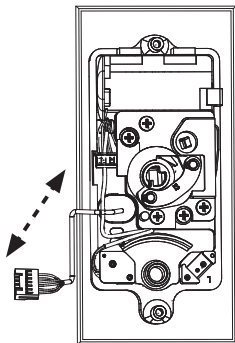
**STEP 5**

Install Battery.

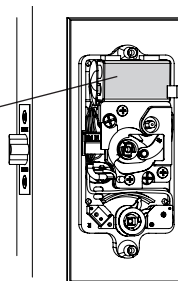
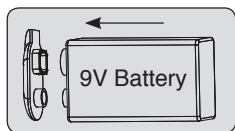

*For optimal performance, always use a good quality battery.*

# 5 Install Inside Trim Plate

Fasten Inside Trim Plate using two #8-32 x  $\frac{3}{8}$ " Flat Head Machine Screws (item #4c).

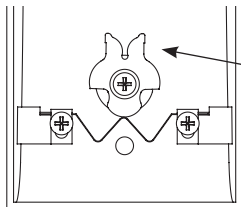

  
*User codes are located on the inside trim plate & back cover page.*

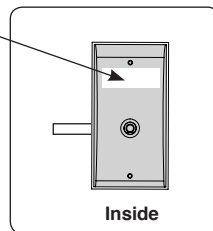

  
*Correct position for installation. Thumbcam must be positioned as shown (Neutral Position)\**

**\*Neutral position** is required for installation and removal of the Inside Trim Plate Assembly.

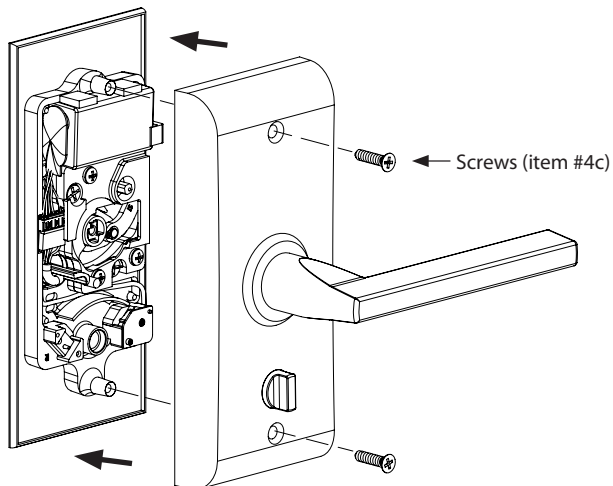



# How to Use

## Your Lock is Ready to Use

EN

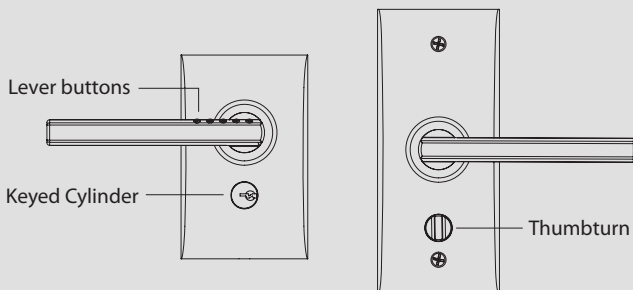

### Using the Lock

Once installed on door with the battery connected - your lock is ready for use.

### Factory Default Setting

User & Master Codes are labeled on the inside trim plate and back cover page.

### Entering User Codes

- Entering a correct, active user code (green LED x1 & beep x1) - unlocks
- Entering an incorrect or inactive code (red LED x2 & beep x2) - remains locked
- Three incorrect entries will result in lockout, signaled by 3 red LED flashes & 3 short beeps, lockout lasts for 30 seconds.

### To Restart Code Entry

Press and hold #1 button for three seconds (this works in entry or programming mode).

### Key Access

Lock may also be unlocked and locked via keyed cylinder, each lock comes with two keys.

### Passage & Privacy Mode

Use inside thumbturn.

Setting	Setting Description	Thumbturn Position	LED Feedback
Thumbturn Enable ON	Lock access is regulated. A correct, active user code is required for access. (Privacy Mode)		Green
Thumbturn Enable OFF	Lock access is NOT regulated. Always Unlocked (Passage Mode)		Amber

# Getting Started

## Device App

App is free and available at App Store (  devices) or Play Store (  devices).

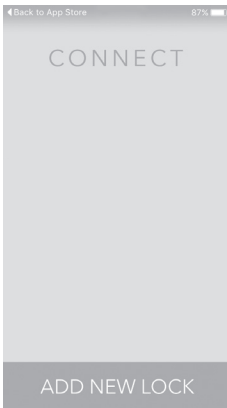
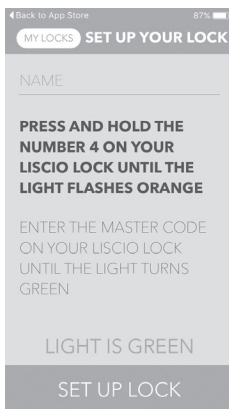
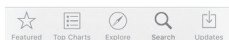
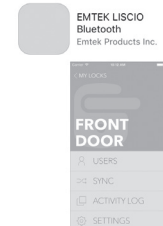
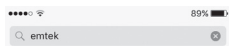

**A** From  devices (iPhone 4S, 5, 5S & 5C; iPad 3rd generation and later running iOS 8 and later)

1. Go to App Store, select Search, enter “Emtek”, select “Emtek Liscio Bluetooth”, select download icon, when ready select Open. If upon opening app you receive a screen that advises you that your device is “Unsupported” you will not be able to run app on this device.

**B** From  devices (OS 4.3 and later)

1. Go to Play Store, select Search icon, enter “Emtek”, select “Emtek Liscio Bluetooth” app, select Install, select Accept, when ready select Open. If app does not appear then your device is running OS prior to 4.3.

**C** Once App is opened you will be on the Welcome screen

1. Selecting Start you will move through the setup wizard, lock will need to be nearby for this.
2. Select Videos, Quick Reference, About or Show Phone Info as needed
3. If you call Emtek for customer service please have the information listed in the Show Phone Info available.

# Programming Features



EN

Once App is setup and you have logged into app you will be on the Home screen – from here you can:

**A Select Users** – you can add, edit and delete users

1. To add user – select + New, enter Name and enter user code (factory set at 4 digits)
2. To edit user – select user to edit, user information will be shown, select Edit, edit as needed, select Update
3. To delete user – select user to edit, user information will be shown, select Edit, select X Delete
4. You must communicate changes to lock before they are recognized at the lock – see Transfer below (B)

**B Select Transfer** – you can send data/setting changes to the lock, view lock activity or get data/settings from the lock

1. Sending data to Lock – to communicate any user adds, edits or deletes along and any settings changes
2. Viewing lock activity – lock activity on app is from last update, you will need to select Get new lock activity to view the latest activity
3. Getting data from Lock – to communicate latest user and setting data from the lock to the app

**C Select Setting** – you can customize some of the lock and app features

1. From the settings screen you can edit the noted settings, scrolling down is Advanced Settings

**D Select Logoff** when you are done or when you want to program a different lock.

**E Battery Status** – when BT communications are successful, an “Operation Complete” screen gives you a battery status.

1. “Good” means battery has the power to operate lock and BT communications.
2. “Low” means battery still has power to operate lock and BT communications but should be replaced. Lock LED shows 4 amber flashes and 4 beeps.
3. “Blackout” means the battery can no longer operate lock and battery must be replaced. Lock LED shows 6 red flashes and 6 beeps
4. Replacement battery should be a high quality 9 volt alkaline battery. Battery is located behind the interior trim plate.

# Troubleshooting

## Verify that device meets minimum requirements



Apple – iPhone 4S, 5, 5S and 5C; iPad 3rd generation and later running iOS 8 or later



Android – running OS 4.3 or later

## Re-pairing App Function

Once App is setup and you have logged into app you will be on the Home screen – from here you can:

**A** Use this action when device to lock communications are not working, but were previously and several retries have failed.

**B How to:**

1. App – Navigate to Login screen, enter the app password, select the door name, move slider “Force Re-Pairing” to ON and then press Login button.

2. Lock – Manually reset lock to factory defaults – press #1 and #5 buttons simultaneously, enter master code, press the #1 and then the #4 buttons

(not simultaneously) and re-enter the master code. LED will blink green once that lock has been reset – OR – disconnect battery and when you reconnect battery hold down any button for 3 seconds, reset will be signaled by LED flashing 3 times and 3 beeps. Once reset the lock’s activity log will be empty and the user and master codes will be back to factory defaults – see labels placed on back cover page or inside of the interior trim plate.

3. Follow app wizard through setup process.



4. Transfer user and master codes and settings on app to lock

## Reset App and Lock

**A** Use this action when device to lock communications are not working, but were previously and several retries have failed.

**B How to:**

1. App – Navigate to Settings screen, scroll down and select “Advanced Settings”, select “Clear database”, at Select desired action: select “Delete this application database”, for Confirm delete move slider to ON, then select Commit Changes. You will be sent back to Welcome screen to start setup wizard from the beginning.

2. Device – (  ) Navigate to main Settings, select Bluetooth, select “i” icon for Emtek 1 under DEVICES, select Forget this Device, and confirm Forget Device. (  ) Navigate to main Settings, select Bluetooth, select Emtek 1 (icon on right side) and then select Unpair.

3. Lock – Manually reset lock to factory defaults (see section 2 above)

4. Follow app wizard through setup process.

5. This will reset all information both app and lock.



## If problem still persists – Remove App from Device, Download Again, Reset Lock

**A** Use this action when action 2 above does not correct Bluetooth communications.

**B How to:**

1. Device – (  ) Press on Emtek icon until all icons shake and have x at corner of apps, select x on Emtek app, press Apple Home Button and apps will return to normal. Go to App Store and download app again and open to start again.

(  ) Navigate to main Settings, select Apps, scroll to find the Emtek icon and press, then select Uninstall.

2. Device – (  ) Navigate to main Settings, select Bluetooth, select “i” icon for Emtek 1 under DEVICES, select Forget this Device, and confirm Forget Device. (  ) Navigate to main Settings, select Bluetooth, select Emtek 1 (icon on right side) and then select Unpair

3. Device – Cycle power off then back on

4. Lock – Manually reset lock to factory defaults. (see section 2 above)

5. Start Emtek app and follow wizard through setup process.

6. This will reset all information both app and lock.

# Manual Programming

EN

The lock can be programmed manually using the keypad buttons 1 through 5. This feature is made available but programming using a smart phone is highly recommended.

## Manual Programming Commands

- 1** To enter programming mode – press the #1 and the #5 buttons simultaneously
- 2** Enter the lock's 6 digit master code (the master code will be on sticker on back cover page and inside trim plate of lock)
- 3** The features below now accessible by entering a combination of two buttons one after the other (not simultaneously)

If You WishTo	Press Button	Actions
Add a code	# 1 and then # 3	Then enter new code and enter again to confirm (factory setting is 4 digit mode)
Delete a code	# 4 and then # 3	Then enter code to delete and enter again to confirm
Change master code	# 3 and then # 3 again	Then enter new master code and enter again to confirm
Turn ON Deny Users	# 4 and then # 1	
Turn OFF Deny Users	# 5 and then # 1	(factory setting is OFF)

***Deny Users can disable or enable all user codes – when ON, no user codes will work, only key operates lock***

Delete all codes	# 5 and then # 5 again	
Set 4 digit code length	# 5 and then # 2	(factory setting is 4 digits)
Set 6 digit code length	# 5 and then # 3	
Turn Beeper ON	# 1 and then # 1 again	(factory setting is ON)
Turn Beeper OFF	# 1 and then # 2	
Turn Extended timeout OFF	# 2 and then # 1	(factory setting is OFF)
Turn Extended timeout ON	# 2 and then # 2 again	

***Extended timeout mode allows for a longer duration of unlock time upon entry of a valid user code.***

Turn Passage switch OFF	# 3 and then # 1	
Turn Passage switch ON	# 3 and then # 2	(factory setting is ON)

***Passage switch mode ON, choose between Passage (lock unsecured) and Privacy (always locked) and OFF lock is always in Privacy (always locked).***

<b>Restore Factory Defaults</b>	enter # 1 and then # 4	enter master code to confirm
---------------------------------	------------------------	------------------------------

## Feedback – LED and Beeper

Condition	Color	Count	Duration	Comment
<b>POWER ON</b>				
Normal Power on	amber	1	long	
Factory default reset	amber	3	long	
Battery low	amber	4	long	
Battery blackout	red	6	long	
<b>USER ACCESS</b>				
Access granted - normal	green	1	long	
Access granted - battery low	amber	4	long	
Access denied - normal	red	2	long	
Access denied - Battery blackout	red	6	long	
Access denied - lockout	red	3	long	
ID input during timeout	red	2	long	
<b>PASSAGE SWITCH</b>				
Lock secured	green	1	long	
Lock unsecured	amber	1	long	
<b>MANUAL PROGRAMMING</b>				
Programming active	amber	1	continuous	Blinks to off on key press
Programming operation success	green	1	medium	
Programming operation failed	red	2	medium	
Programming cancelled	amber	2	medium	
Programming time out	amber	2	medium	After 20 seconds
<b>BLUETOOTH PROGRAMMING</b>				
BT enable interval	amber	1	long	Delay for entering BT
Programming active	green	1	continuous	
Programming completed - normal	green	1	medium	
Programming completed - battery low	amber	4	long	
Programming completed - battery blackout	red	6	long	
Programming cancelled or time out	red	2	medium	
Programming failed	red	2	medium	After 60 seconds
<b>KEY PRESS</b>				
User Access	amber	1	short	
Manual Programming	OFF	1	short	Blink against solid amber

U.S. patents:	Canadian patents:
8,176,761	2,698,041
8,141,400	2,789,278
	2,789,280



ASSA ABLOY is the global  
leader in door opening solutions,  
dedicated to satisfying  
end-user needs for security,  
safety and convenience.



EMTEK Products, Inc.  
15250 E. Stafford Street  
City of Industry • CA 91744  
Tel: 800-356-2741 • 626-961-0413  
Fax: 800-577-5771 • 626-336-2812  
[emtek.com](http://emtek.com)

Place Sticker Here



Copyright © 2017, Emtek Products, Inc. an ASSA ABLOY Group company. All rights reserved. Reproduction in whole or in part without the express written permission of Emtek Products, Inc. is prohibited.

IN8-LISCIO

REV 17A 1/30/17