

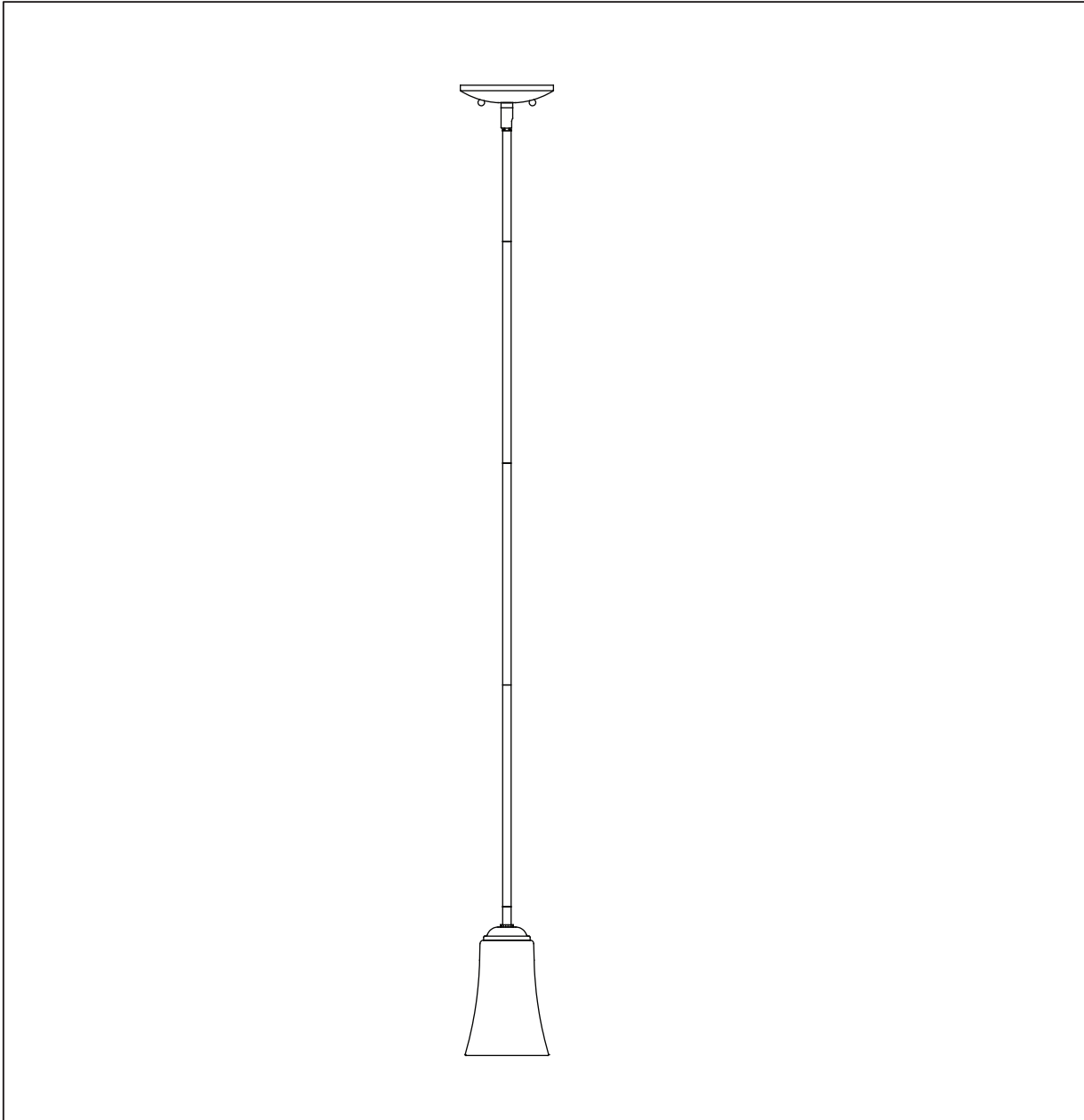

PRODUCT NAME: Logan 1-Light Mini Pendant
ITEM NUMBER: 92040

Please consult your electrician for hanging fixture and wiring.



Bulb (not included): 1x60W Medium Base Bulb

IMPORTANT: Turn off the power at the main fuse or circuit breaker box before starting installation

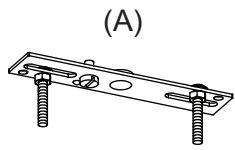

(A)
Bracket

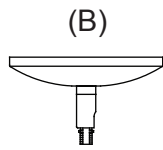

(B)
Canopy



(C)
Ball Nuts(2Pcs)



(E)
Mounting Screws(2Pcs)

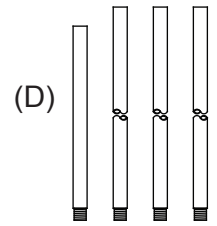

(D)
Rods(1*6" +3*12")*1

Locate all hardware & components before discarding packaging

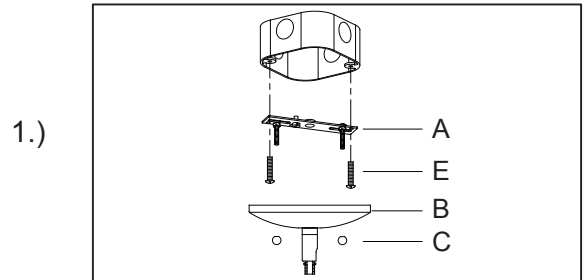
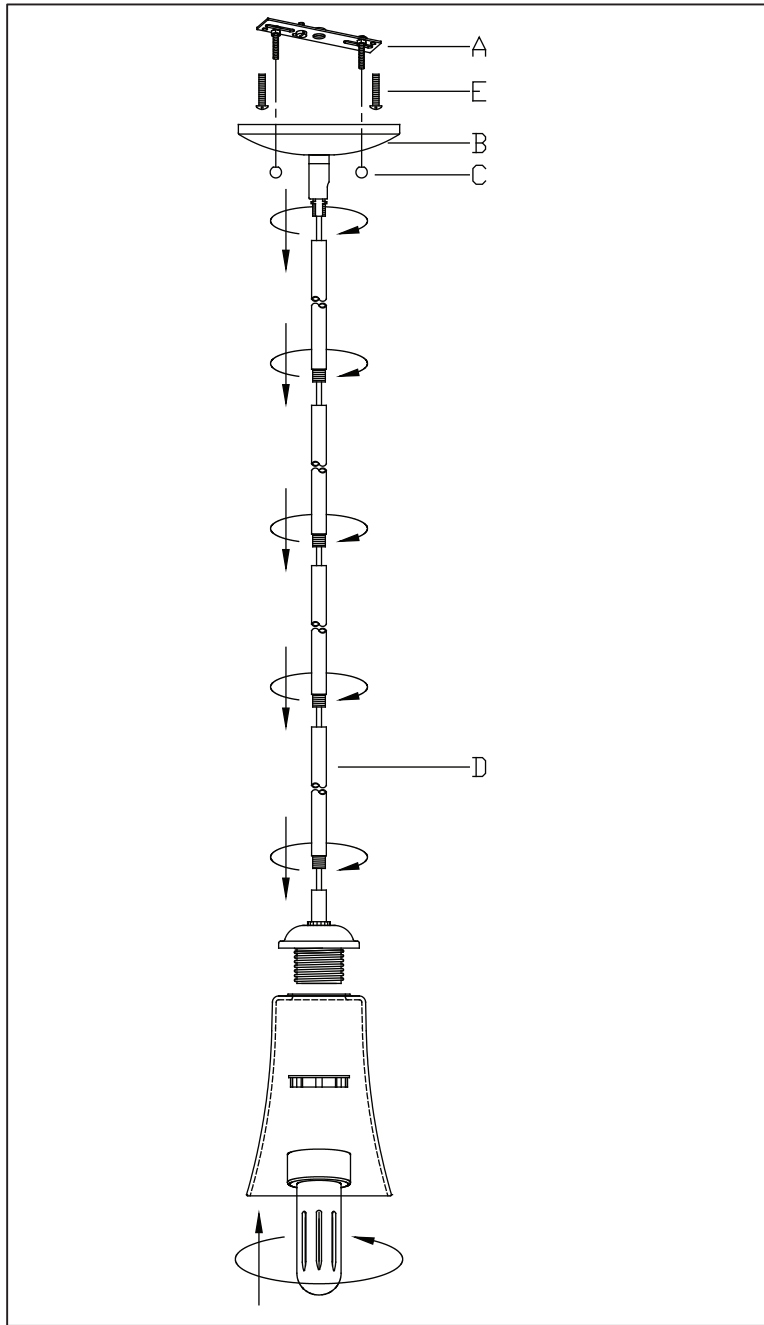

1.)

Step1:Remove mounting bracket from fixture and install to electrical box.

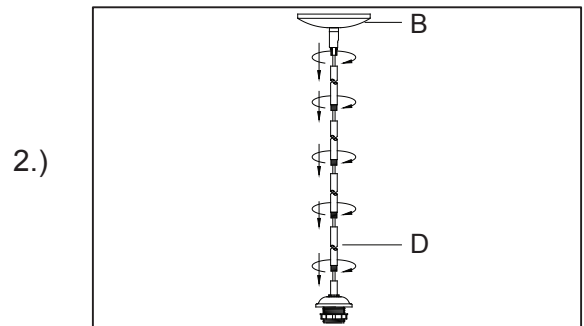

2.)

Step2:Run wire through stems and combine stem lengths to meet desired mounting height.

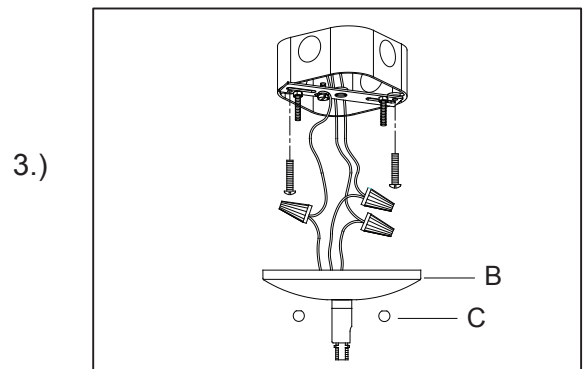

3.)

Step3:Wire fixture to wires in outlet box. Copper wire is for Ground. Attach canopy to mounting bracket and tighten with ball nuts.

Cleaning & Care:
Clean with soft cloth and a mild detergent.
Do not use abrasive cleaner.