

Passage (Closet/Hall)

401

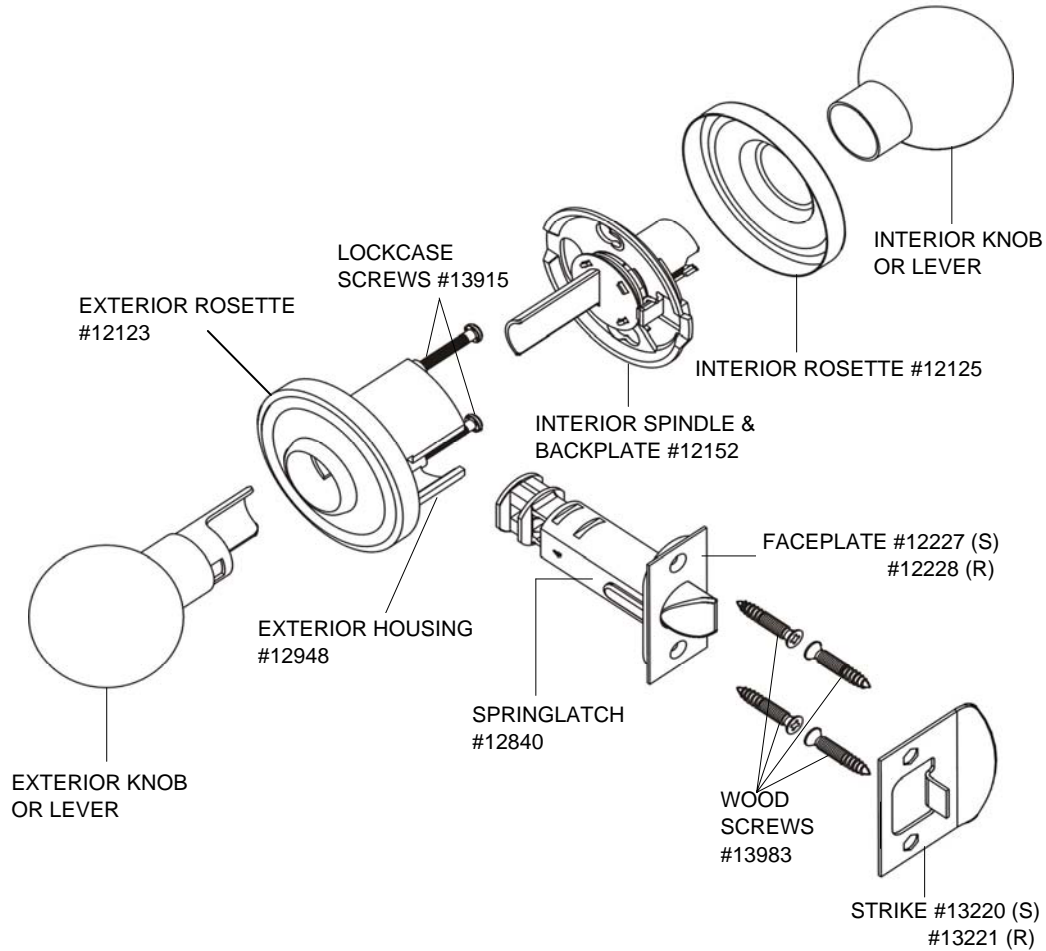

Note: Exterior Housing and Interior Spindle & Backplate accommodates standard door thickness 1 3/8" to 1 3/4" (35-44 mm)

* Finishes available: (See Price Book)

Latch & Strike Screws		
Wood Door & Jamb		13983
Metal Door		13903
Metal Jamb		13902
Knob & Lever Styles		
Interior	Knob/Lever Style	Exterior
70046	Barrington Knob	20021
12027	Sonic Lever	12030
12232	Non-Handed Lexington Lever	12233
12350	Non-Handed Provence Lever	15509

Springlatch			
		Knob	Lever
401	Convertible Backset 2 3/8" to 2 3/4" (60-70 mm)	12840	32840